

D-SUB STANDARD – IP67

Solder pin – Angled – .189"/4.8 mm – Precision machined contacts – Metal bracket

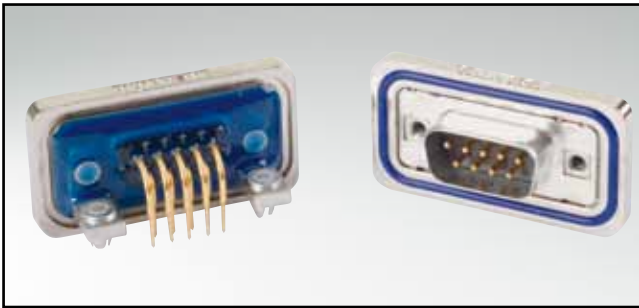

RoHS compliant - CSA listed, File No.LR115000-1 UL listed, File No. E202784

SOCKET CONNECTOR

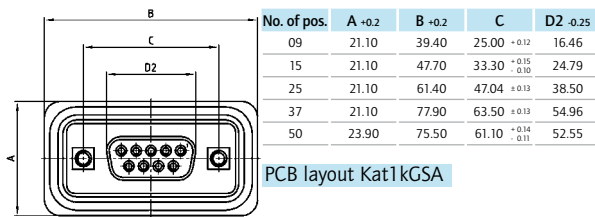

Mounting style: Mounting bracket, threaded insert

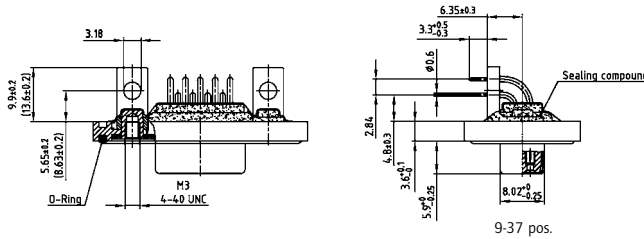

Mounting style: PCB clip, threaded insert

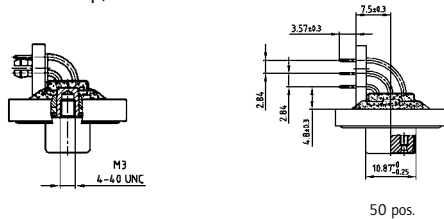

ORDER DATA

SOCKET CONNECTOR		
No. of pos.	Mounting style	Part Number
09	M3 Threaded insert	6 STD09SAT99S10 X
15	M3 Threaded insert	6 STD15SAT99S10 X
25	M3 Threaded insert	6 STD25SAT99S10 X
37	M3 Threaded insert	6 STD37SAT99S10 X
50	M3 Threaded insert	6 STD50SAT99S10 X
09	4-40 UNC Threaded insert	6 STD09SAT99S20 X
15	4-40 UNC Threaded insert	6 STD15SAT99S20 X
25	4-40 UNC Threaded insert	6 STD25SAT99S20 X
37	4-40 UNC Threaded insert	6 STD37SAT99S20 X
50	4-40 UNC Threaded insert	6 STD50SAT99S20 X
09	PCB clip / M3 Threaded insert	6 STD09SAT99S30 X
15	PCB clip / M3 Threaded insert	6 STD15SAT99S30 X
25	PCB clip / M3 Threaded insert	6 STD25SAT99S30 X
37	PCB clip / M3 Threaded insert	6 STD37SAT99S30 X
50	PCB clip / M3 Threaded insert	6 STD50SAT99S30 X
09	PCB clip / 4-40 UNC Threaded insert	6 STD09SAT99S40 X
15	PCB clip / 4-40 UNC Threaded insert	6 STD15SAT99S40 X
25	PCB clip / 4-40 UNC Threaded insert	6 STD25SAT99S40 X
37	PCB clip / 4-40 UNC Threaded insert	6 STD37SAT99S40 X
50	PCB clip / 4-40 UNC Threaded insert	6 STD50SAT99S40 X

DESCRIPTION

- Mounting styles:
 - with mounting bracket and 4-40 UNC or M3 threaded insert including hex locking bolt
 - with mounting bracket, PCB clip and M3 or UNC 4-40 threaded insert including hex locking bolt
- Quality class 3 (also available in quality class 1)
- Shell: Brass tin plated (stainless steel available on request)
- Nickel plated die-cast frame (Black plastic frame on request)

PLUG CONNECTOR

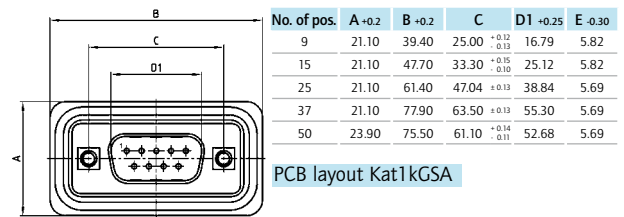

Mounting style: Mounting bracket, threaded insert

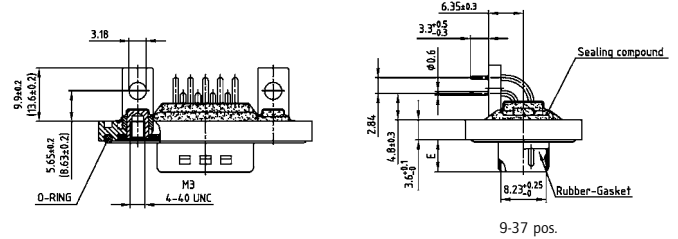

Mounting style: PCB clip, threaded insert

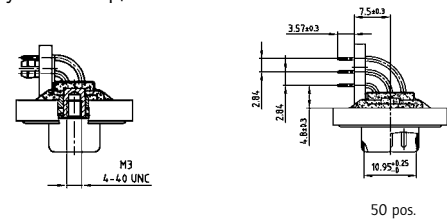

PCB clip .122"/3.1 ± .004"/0.10 mm hole diameter and .063"/1.6 mm circuit board thickness