

Data Sheet

PT094xxVBBN

Page 1/5

P/N

313831xx

xx=number of poles

Illustration

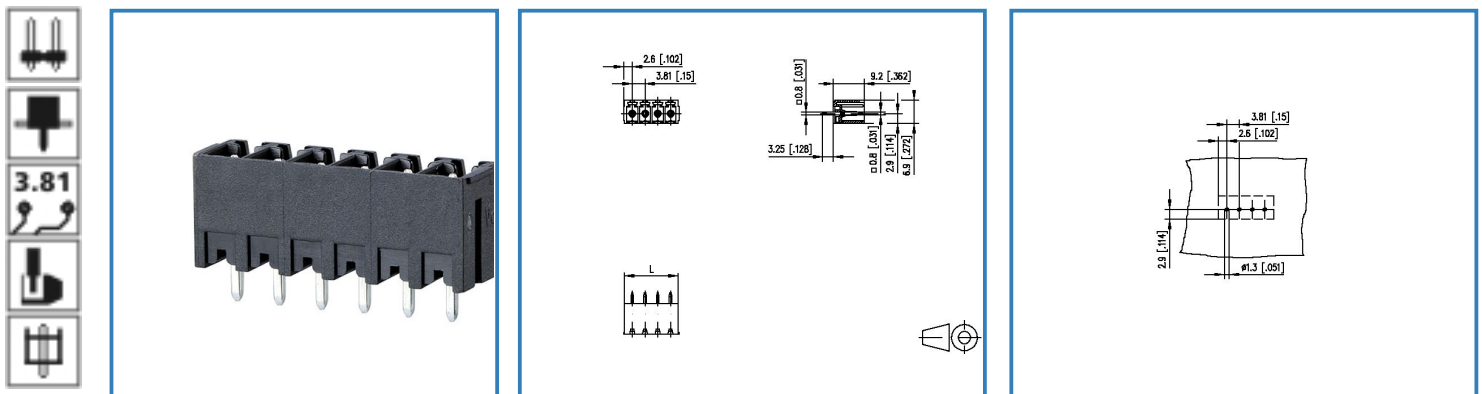

see enlarged drawing at the end of the document

Product specification

- pin header, solderable
- centerline 3.81 mm, direction of connection vertical 0°
- closed ends
- color black
- codeable
- Connection data

CRIUS V / A 300 / 8

SEV 160 V / 2.5 kV / 9 A

Data Sheet



PT094xxVBBN

Technical Data

General Data

Solder pin length	3.25 mm		
min. number of poles	2		
max. number of poles	24		
Insulating material class	CTI 600		
clearance/creepage dist.	3.01 mm		
protection category	IP 00		
Overvoltage category	III	III	II
Pollution degree	3	2	2
Rated voltage	200 V	500 V	500 V
Rated test voltage	2.5 kV	4 kV	2.5 kV

Connection data

 V / A	300 / 8
	160 V / 2.5 kV / 9 A

Material

insulating material	PA66
flammability class	V0
contact pin material	CuFe
contact pin surface	Ni + Sn

Climatic properties

upper limit temperature	105 °C
lower limit temperature	-40 °C

General

solderability	For THR products acc. to IPC/JEDEC J-STD-020D-MSL 1 For THT products max. 260 °C / 10 s
Tolerance	ISO 2768 -mH

Data Sheet

PT094xxVBBN

Page 3/5

P/N

313831xx

xx=number of poles

Matching Part to

P/N	Product name
311131	Type 113
311141	Type 114
313691	Type 369
ASP064	ASP064

Accessories

P/N	Product name
720293-01-2	Kodierstern für STL RM 3,81

Data Sheet

PT094xxVBBN

Page 4/5

P/N

313831xx

xx=number of poles

Illustration

Drawing

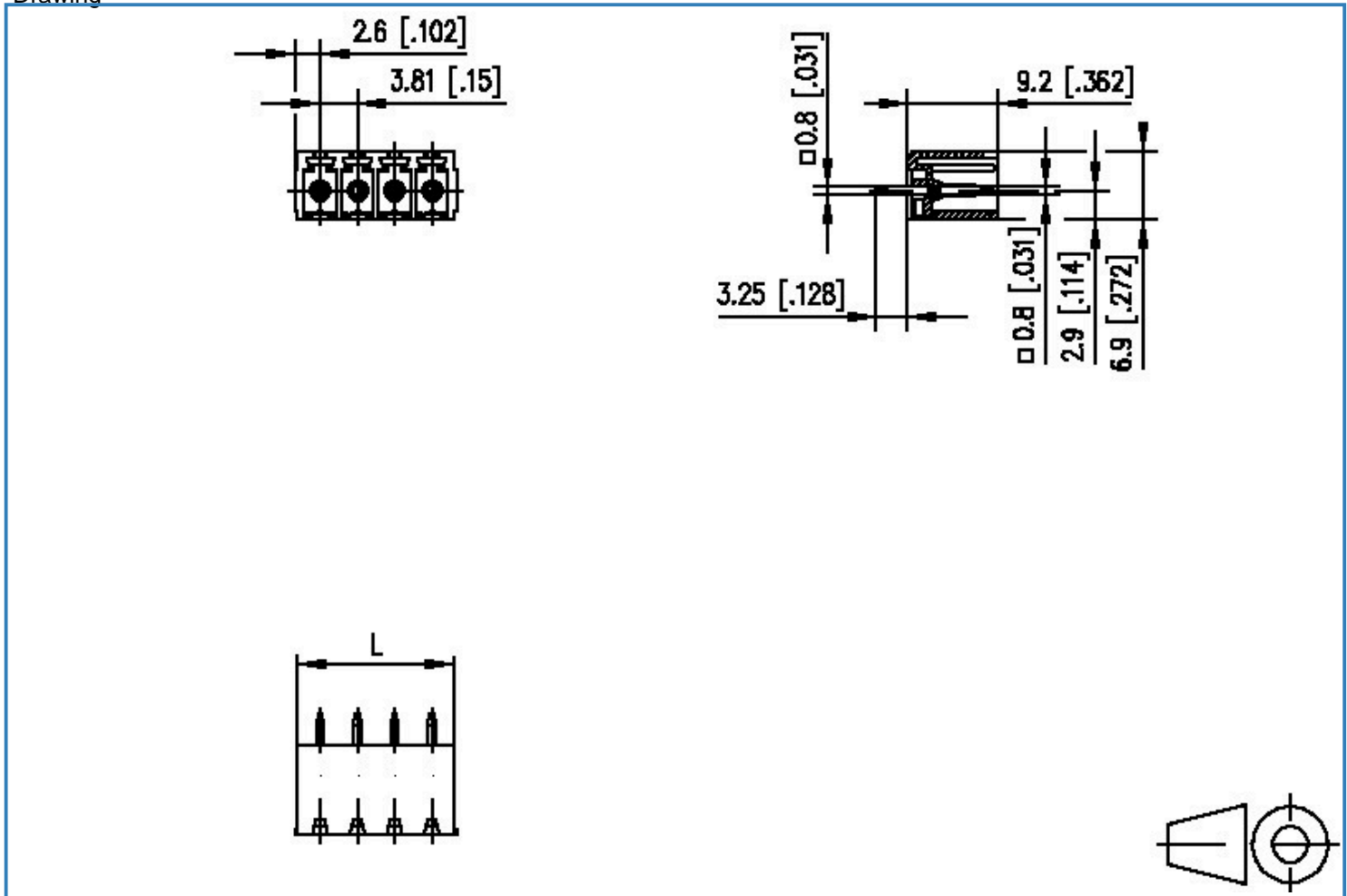

$$L = (\text{pole size} - 1) \times \text{centerline} + 5.2 [0.205]$$

Data Sheet

PT094xxVBBN

Page 5/5

P/N

313831xx

xx=number of poles

PCB Layout

