

Data Sheet

RP023xxHBWC

(Type 166)

Page 1/5

Order Number

311661xx

xx=number of poles

Illustration

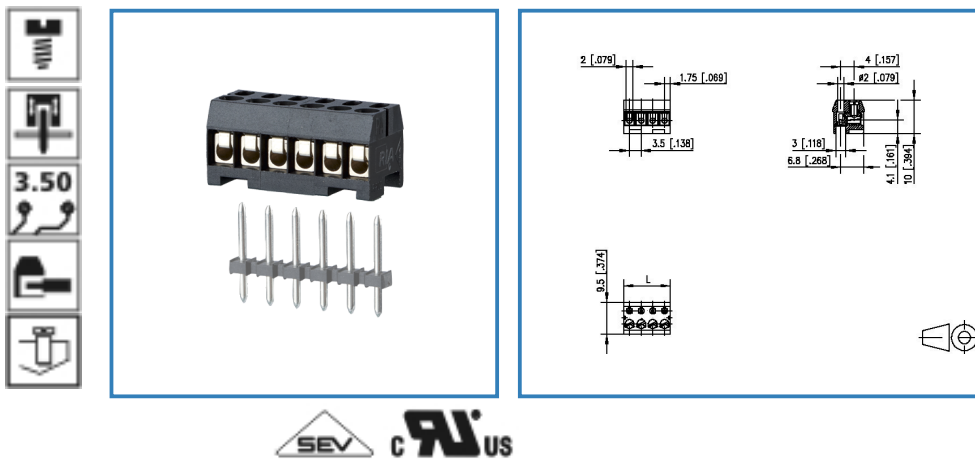

see enlarged drawing at the end of the document

Product specification

- screw type terminal block, pluggable
- centerline 3.50 mm, direction of connection 90°
- CuNiZn, fittable without loss of poles
- color black
- Wire entry perpendicular to plug direction
- Connection data

CRUS V / A / AWG 125 / 8 / 28 - 16

SEV 0.08 - 1 mm² 200 V / 2.5 kV / 6 A

Data Sheet

RP023xxHBWC

(Type 166)

Page 2/5

Order Number

311661xx



xx=number of poles

Technical Data

General Data

Tightening torque SEV	0.15 Nm		
Tightening torque UL	3 lb-in		
min. number of positions	2		
max. number of positions	24		
Insulating material class	CTI 600		
clearance/creepage dist.	2 mm		
protection category	IP 00		
Overvoltage category	III	III	II
Pollution degree	3	2	2
Rated voltage	160 V	400 V	400 V
Stossspannung	2.5 kV	4 kV	2.5 kV

Connection data

 V / A / AWG	125 / 8 / 28 - 16
 0.08 - 1 mm ²	200 V / 2.5 kV / 6 A

Material

insulating material	PA66
flammability class	V0

Data Sheet

RP023xxHBWC

(Type 166)

Page 3/5

Order Number

311661xx

xx=number of poles

terminal body material	CuZn
terminal body surface	Ni
screw surface	Cu + Ni
wire protector material	CuNiZn
screw thread	M2

Climatic properties

upper limit temperature	105 °C
lower limit temperature	-40 °C

General

tolerance	ISO 2768 -mH
-----------	--------------

Matching Part

312241	Type 224
312251 (on request)	Typ 225
312261 (on request)	Type 226
314241	Typ 424

Accessories

720158-01-0 (on request)	Befestigungsflansch kurz LP1mm
--------------------------	--------------------------------

Data Sheet

RP023xxHBWC

(Type 166)

Page 4/5

Order Number

311661xx

xx=number of poles

720158-01-2	Flansch für Typ 166
720158-02-2	Flansch für Typ 166
720159-01-0 (on request)	Kodierstift kurz
720159-01-2	Kodierstift kurz für Typ 166
720159-02-0 (on request)	Kodierstift lang
720159-02-2	Kodierstift lang für Typ 166

Data Sheet

RP023xxHBWC

(Type 166)

Page 5/5

Order Number

311661xx

xx=number of poles

Illustration

Drawing

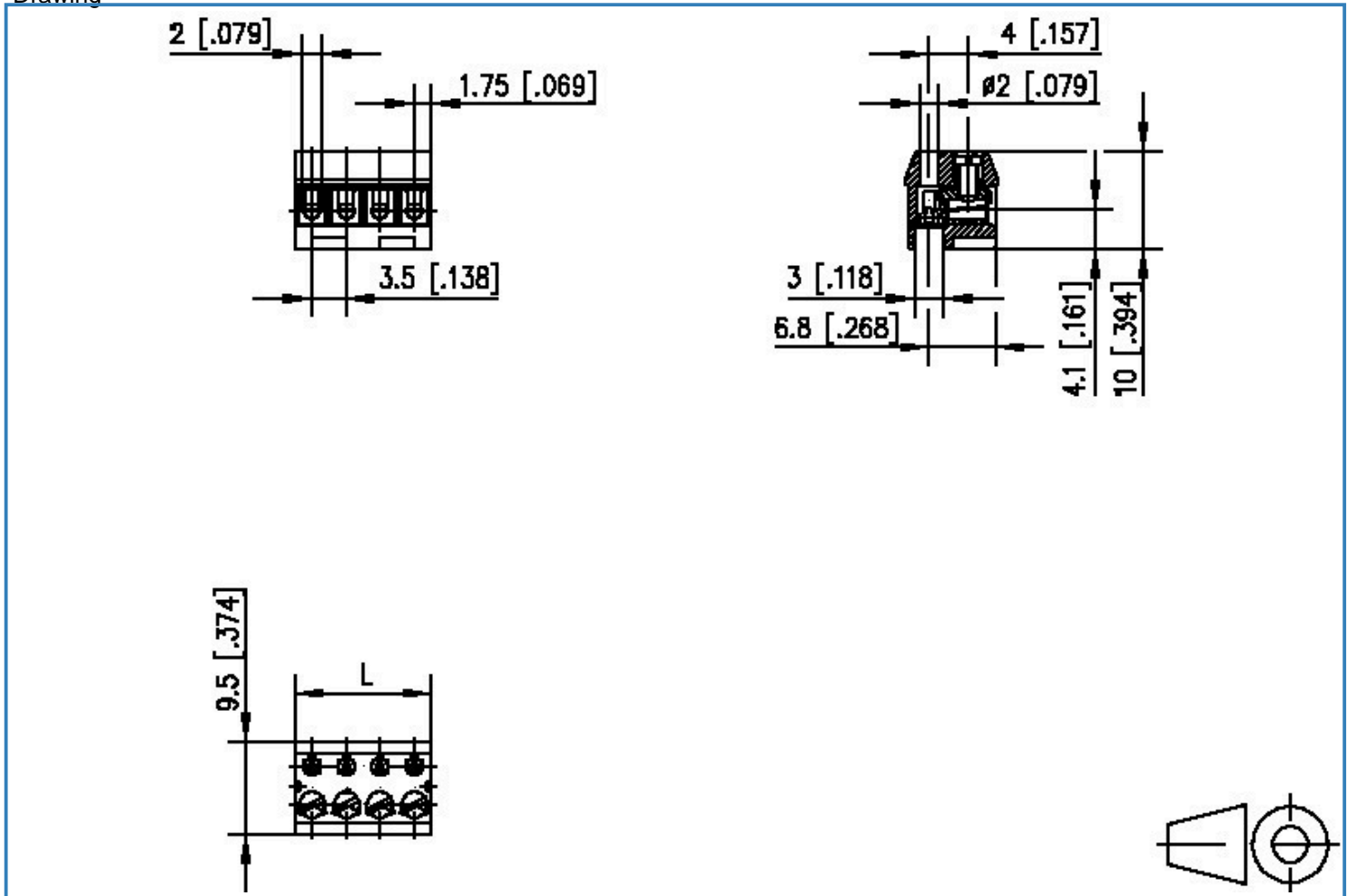

$$L = (\text{pole size} - 1) \times \text{centerline} + 3.5 [0,138]$$