

used for: D-SUB

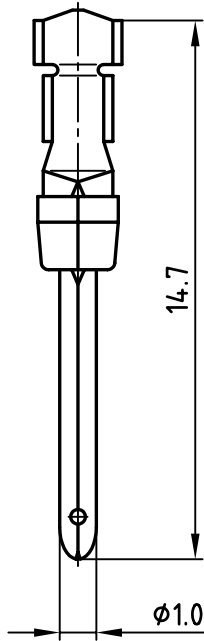

NOTES:

- Material stamped Contacts: phosphor bronze
- Finish: min. 8µ" hard-gold-plated in the contact area
- Temperature range: -55°C to +125°C
- Rated current: 7.5A
- Test voltage: 1000V eff. at 50Hz
- Contact resistance: <= 10mOhm
- Insulation resistance: >= 5000MOhm

Directive 2002/95/EC
 „RoHS“
 Compliant

THIS DRAWING MAY NOT BE COPIED OR REPRODUCED IN ANY WAY, AND MAY NOT BE PASSED ON TO A THIRD PARTY WITHOUT WRITTEN PERMISSION.
 OWNERSHIP AND COPYRIGHT OF CONEC GmbH
 DO NOT ALTER CAD DRAWING BY HAND

rev.	description	date	name	tolerance
		2002	date	
		drawn	11.01.	name
		appd.	11.01.	Parei
		norm		Resonnek
		d-old		
CONEC®				

scale:	5:1
material:	SEE NOTES
title:	PLUG CONTACT CRIMP AWG24-20
dwg no:	AutoCAD 2000
part no:	16K2A430A
	161A13399X
	DIN-A 4 sh: 1/1